

**SURFACE MOUNT  
SPST BALANCED MAGNETIC SWITCH  
1000-65Y BMS**



**FEATURES:**

- \* Surface Mount Switch and Magnet
- \* 18" Armored Cable, #22 AWG Wire Leads
- \* Balanced Magnetic Configuration with Magnetic Tamper
- \* Solid Aluminum Case
- \* Lifetime Warranty
- \* Safety Approvals



**SWITCH AND MAGNET DIMENSIONS**

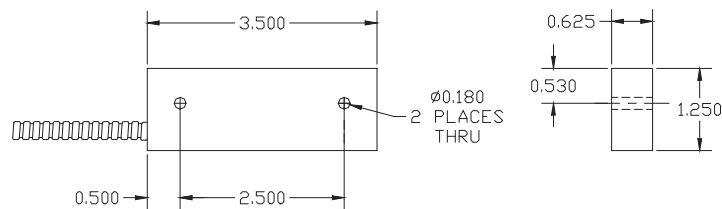

**PRINCIPAL OF OPERATION:** The Flair 1000-65Y BMS Balanced Magnetic Contact utilizes two Form A high reliability Rhodium plated reed switches, one of the two reed switches being of different sensitivity, encapsulated in epoxy inside a recessed mounted fire retardant case. This results in SPST configuration with magnetic tamper. When the rare earth magnet is in place and properly adjusted (balanced), the magnetic tamper switch 2 will be in a state opposite to the switch 1. This normal configuration will change should one of the following occur; (1) switch 1 will change state by either the deliberate shunting of the magnetic field or if the door/window is opened, and (2) the addition of a magnetic field such as an external magnet will cause the magnetic tamper switch 2 to change state.

End-of-line resistors may be used to allow a pre-determined trickle of current to flow and permit operation from a supervised line at all times. Call Flair to request help with specifying the correct resistors. See Installation Instructions for more information

**WIRE COLOR CODE BASED ON LOOP TYPE WHEN THERE IS MORE THAN ONE SWITCH AND MAGNET IS PRESENT**

		Common	Closed	Open
Loop	Switch 1	Green	Red	
	Switch 2 Magnetic Tamper	Black/White		Blue/White

**SPECIFICATIONS**

**ELECTRICAL:**

Circuit: SPST with Magnetic Tamper  
 Voltage: 100VDC Max.  
 Current: 50ma. Max.  
 Wattage: 10 Max.

**MECHANICAL:**

Gap on steel: 0 TO 1/2"  
 Housing: Solid Aluminum Construction