

**RECESSED 1" DIA.  
DPDT BALANCED MAGNETIC SWITCH  
MSS100-4V BMS**



**FEATURES:**

- \* 1" Dia. Recessed Magnetic Contact
- \* 12" #22 AWG Wire Leads
- \* Adjustable Rare Earth Magnet
- \* Self Locking in Steel and Wood
- \* Balanced Magnetic Configuration with Magnetic Tamper
- \* Colors: White, Brown, Black and Gray
- \* Lifetime Warranty
- \* Safety Approvals



MAGNET HOLDER AND  $\varnothing 1/4" \times 1/2"$  RARE EARTH MAGNET  
MAGNET HOLDER SCREWS IN AND OUT TO ADJUST GAP

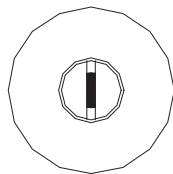

ADJUSTABLE MAGNET

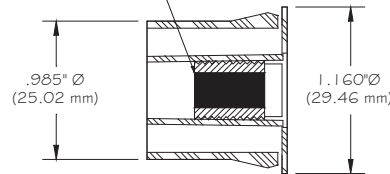

SWITCH

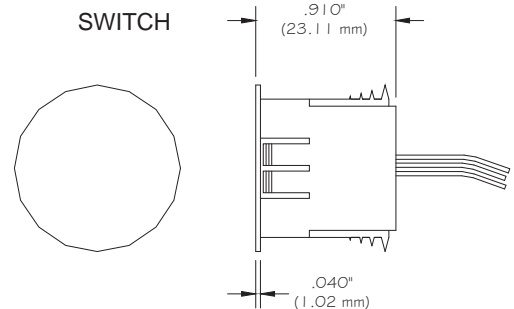

**PRINCIPAL OF OPERATION:** The Flair MSS100-4V BMS Balanced Magnetic Contact utilizes three Form C high reliability Rhodium plated reed switches, one of the three reed switches being of different sensitivity, encapsulated in epoxy inside a recessed mounted fire retardant case. This results in DPDT configuration with magnetic tamper. When the rare earth magnet is in place and properly adjusted (balanced), the magnetic tamper switch will be in a state opposite to the other two switches. This normal configuration will change should one of the following occur; (1) switches 1 and 3 will change state by either the deliberate shunting of the magnetic field or if the door/window is opened, and (2) the addition of a magnetic field such as an external magnet will cause the magnetic tamper switch 2 to change state.

End-of-line resistors may be used to allow a pre-determined trickle of current to flow and permit operation from a supervised line at all times. Call Flair to request help with specifying the correct resistors. See Installation Instructions for more information.

**WIRE COLOR CODE BASED ON LOOP TYPE  
WHEN MAGNET IS PRESENT**

		Common	Closed	Open
Loop	Switch 1	Green	Red	White
	Switch 2 Magnetic Tamper	Black/White	Brown/White	Blue/White
	Switch 3	Gray	Yellow	Violet

**SPECIFICATIONS**

**ELECTRICAL:**

Circuit: DPDT with Magnetic Tamper  
Voltage: 100VDC Max.  
Current: 50ma. Max.  
Wattage: 10 Max.

**MECHANICAL:**

Gap in steel: 0" TO 3/8"  
Housing: Fire Retardant High Impact Plastic